

**CITY OF GRANITE FALLS**

**ORDINANCE NO. 798-10**

**AN ORDINANCE MODIFYING ORDINANCE 759-07 THE MILLER SHINGLE  
ANNEXATION BY REMOVING ABUTTING RIGHT-OF-WAY FROM THE  
CITY LIMITS**

**Whereas**, on February 20, 2008 pursuant to RCW 35A.14 the City of Granite Falls annexed that area of Snohomish County within Section 7, Township 30 North, Range 7 East, known as the Miller Shingle annexation; and

**Whereas**, a portion of that annexation included the Mountain Loop Highway abutting the Miller Shingle property; and

**Whereas**, a portion of that annexation included the southerly one-half of the South Fork of the Stillaguamish River in order to minimize potential jurisdictional conflicts; and

**Whereas**, the resulting boundaries of the Miller Shingle annexation included one-half of Snohomish County Bridge #102 over the Stillaguamish River; and

**Whereas** RCW 35A.21.210 allows counties and code cities to revise and adjust boundaries to coincide with appropriate right of way lines;

**Whereas**, the bridge is in need of repair; and

**Whereas**, Snohomish County has approved funding to complete these repairs; and

**Whereas**, Snohomish County has plans for long term repairs and possible replacement of the bridge; and

**Whereas**, Snohomish County would like to retain ownership of the bridge, and approaches to it, for ease of future maintenance and repair;

**Whereas**, it is anticipated that the Snohomish County Council will likewise pass an ordinance or resolution revising and adjusting the corporate boundary as provided herein;

**NOW THEREFORE**, the City Council of the City of Granite Falls, Washington do ordain as follows:

Section 1. The legal description referenced as Exhibit A in Ordinance 759-09 is hereby replaced with the attached Exhibit A which removes that portion of the Mountain Loop Highway abutting the Miller Shingle property, and one half of the bridge (the southwest half) from the City limits.

Section 2. Severability. If any section, subsection, sentence, clause, phrase or word of this ordinance should be held to be invalid or unconstitutional by a court of competent jurisdiction, such invalidity or unconstitutionality thereof shall not affect the validity or constitutionality of any other section, subsection, sentence, clause, phrase or word of this ordinance.

Section 3. Effective Date. This ordinance shall take effect five days after the date of its publication by summary and passage of a corresponding ordinance or resolution of the Snohomish County Council..

ADOPTED by the City Council and APPROVED by the Mayor this 21 day of APRIL, 2010.

CITY OF GRANITE FALLS

By   
Sheikh Haroon Saleem, Mayor

ATTEST:

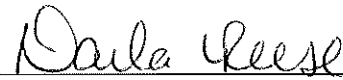
By   
Darla Reese, City Clerk

APPROVED AS TO FORM:

By   
Thom H. Graafstra, City Attorney

Date of First and Last Reading: April 21, 10

Date of Publication: April 25, 10

Effective Date: April 30, 10

# EXHIBIT A

## Granite Falls - A portion of Section 7, Township 30 North, Range 7 East, W.M.

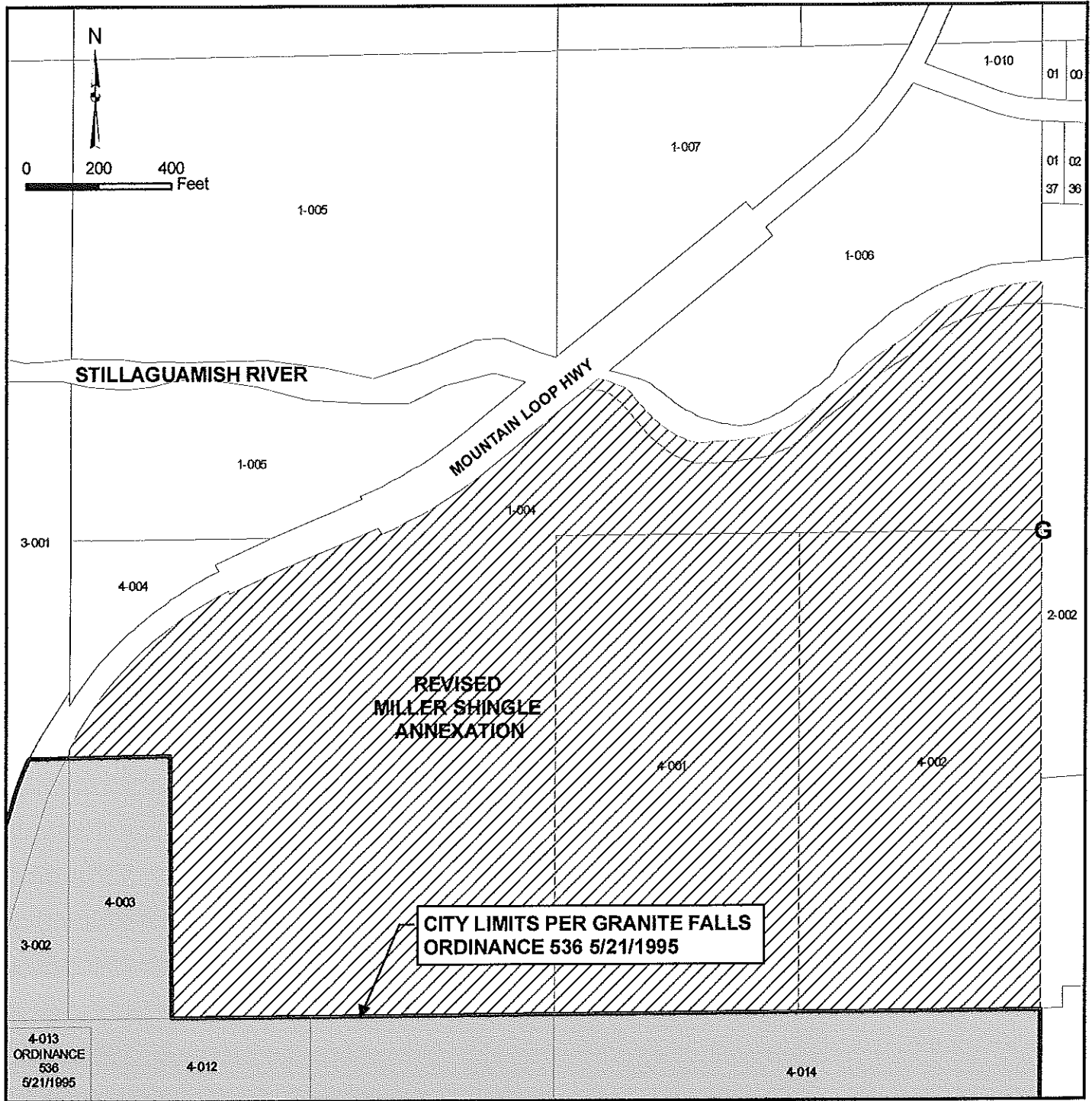

The portion of Section 7, Township 30 North, Range 7 East Willamette Meridian described as follows:

Beginning at the southeast corner of the north half of the southeast quarter of said Section 7; thence North along the east line of said section to the middle of the South Fork of the Stillaguamish River; thence West along the middle of said river to the easterly margin of the Mountain Loop Highway, thence southwesterly along said margin to an interstecion with the west line of the NW 1/4 of the SE 1/4 of said Section 7; thence south along said west line to the northwest corner of the west 288.5 feet of the south 712.10 feet of the northwest quarter of the southeast quarter of said Section 7; thence East along said north line to the northeast corner of said west 288.5 feet of the south 712.10 feet; thence South along the east line of said west 288.5 feet of the south 712.10 feet to the southeast corner thereof; thence East along the south line of the north half of the southeast quarter of said Section 7 to the point of beginning.